

RESORTS

- \$100 million renovation completed June 2022
- Located within an hour drive from Philadelphia and a two-hour drive from New York City.
- 12 miles from the Atlantic City International Airport, quarter-mile from the Atlantic City bus terminal and 60 miles from the Philadelphia International Airport.
- Total of 1,215 guest rooms and suites, including a complete renovation of all 750 guestrooms in the Bally's Tower
- Complimentary Wi-Fi in all guest rooms as well as public spaces.
- Brand new lobby and 360-degree rotating Carousel Bar overlooking the casino floor.
- On-site parking garage easily accessible to the front entrance, lobby and meeting levels.

MEETINGS & EVENTS

- Over 100,000 square feet of flexible indoor/outdoor event space.
- Over 33 meeting rooms, including two executive boardrooms.
- Spacious pre-function meeting/event space with available seating for social events
- Easily accessible and dedicated meeting room level with two built-in registration areas.
- Grand Ballroom, Bally Ballroom & Ocean Ballroom with the capacity to fit up to 4,000 attendees while overlooking the boardwalk and ocean.
- Audio/Visual services on site.
- Business Center
- Dedicated on-site Sales & Convention service professionals.

DINING & RECREATION

- Over 11 dining concepts, from casual to upscale, both indoor and outdoor, many with private dining options for groups.
- Gourmet restaurants including Guy Fieri's Chophouse and Jerry Longo's Meatballs & Martinis.
- The Yard, indoor/outdoor dining and entertainment venue is open year-round.
- Bally's Beach Bar with private cabanas. Open seasonally.
- Public beach with seasonal water sports available.
- Retail shop includes various sundries and apparel.
- Revitalized casino floor, including 1400 slot machines, 80 table games.



Bally's
ATLANTIC CITY

1900 Pacific Ave. Atlantic City, NJ 08401
ballysac.com • 609-340-2000

f @ballysac



**MEET. GREET.
STAY. PLAY.**

Bally's
ATLANTIC CITY

MEETING FACILITIES MAP

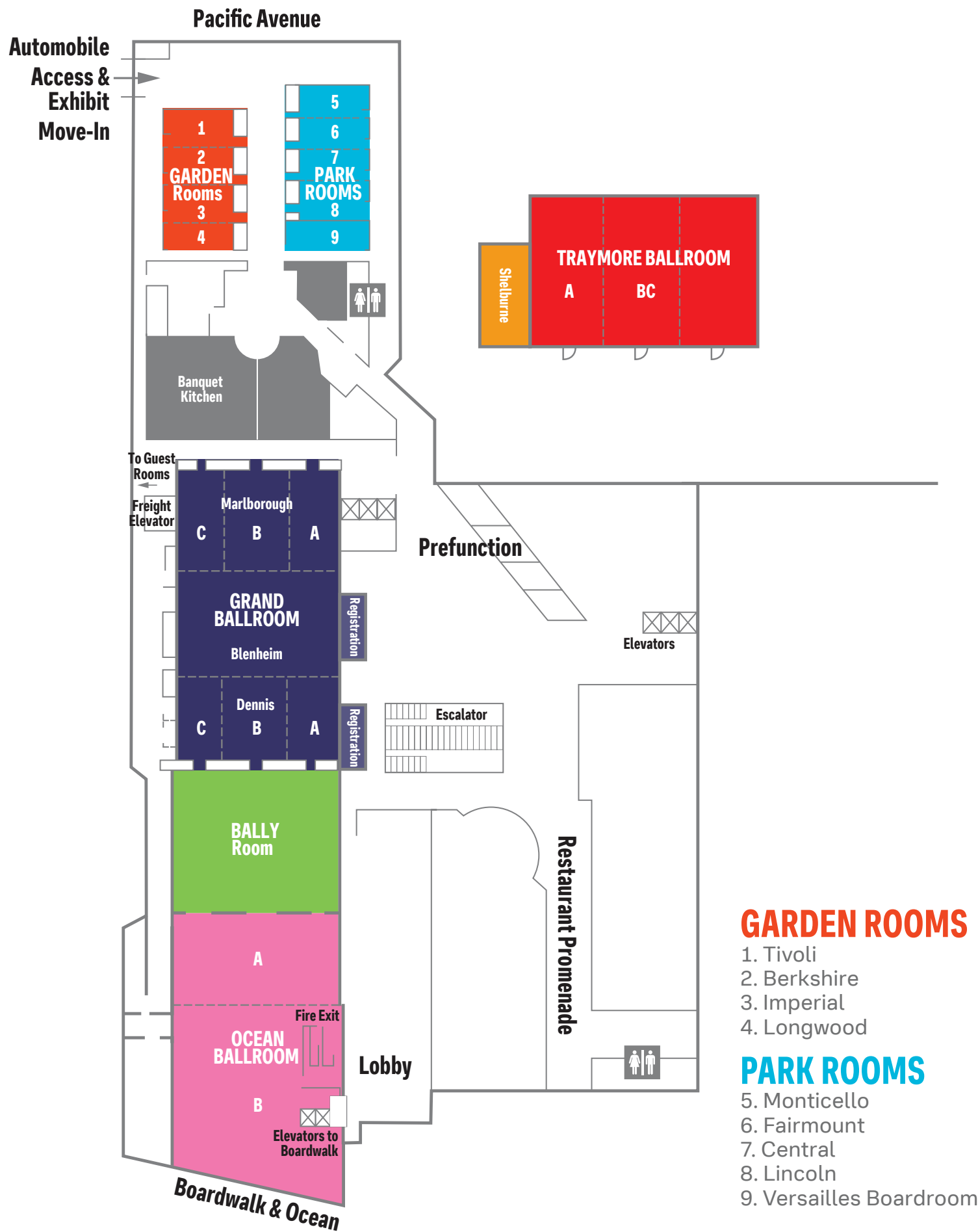

PROPERTY MAP



CAPACITIES & DIMENSIONS

MEETING ROOMS	SQ. FT.	WIDTH	LENGTH	CEILING	CLASSROOM	THEATER	RECEPTION	BANQUET	EXHIBITS	U-SHAPE
H-SQUARE										
GRAND BALLROOM	14,432	164'	88'	16'	1,029	1,760	1,950	1,120	103177	—
Marlborough	5,104	58'	88'	16'	408	648	500	350	38/28	102
Marlborough A	1,508	58'	26'	16'	96	190	150	100	9/8	57
Marlborough B	2,088	58'	36'	16'	135	264	200	150	15/10	62
Marlborough C	1,508	58'	26'	16'	126	198	150	100	10/10	57
Blenheim	4,928	56'	58'	16'	342	558	480	400	38/28	100
Dennis	4,048	46'	88'	16'	285	450	400	300	31/23	88
Dennis A	1,242	46'	27'	16'	60	108	120	90	8/7	45
Dennis B	1,564	46'	34'	16'	105	162	160	120	8/8	48
Dennis C	1,242	46'	27'	16'	75	108	120	90	8/8	45
Prefunction Space	10,000	—	—	—	—	800	—	—	—	—
TRAYMORE BALLROOM	13,000	160'	72'	18'	800	1,200	1,200	850	90	—
Traymore A	4,300	50'	72'	18'	300	400	400	275	30	100
Traymore B	4,300	50'	72'	18'	300	400	400	275	30	100
Traymore C	4,900	60'	80'	18'	300	400	400	275	30	100
OCEAN BALLROOM	12,103	148'	80'	14'	780	1,065	1,180	800	82/69	—
Ocean A	5,301	57'	93'	14'	378	486	520	350	39/30	101
Ocean B	6,402	104'	66'	14'	450	579	625	450	43/38	95
BALLY ROOM	6,231	67'	93'	9'9"-15'11"	180	348	610	340	31/27	90
GARDEN ROOMS	3,108	37	84	12	204	300	305	200	15	90
Longwood	703	37	19	12	42	72	65	30	—	18
Imperial	703	37	19	12	42	72	65	30	—	18
Berkshire	703	37	19	12	42	72	65	30	—	18
Tivoli	999	37	27	12	60	100	98	60	—	18
PARK ROOMS	2,812	37	76	12	192	276	280	180	11	86
Lincoln	703	37	19	12	42	72	65	30	—	18
Central	703	37	19	12	42	72	65	30	—	18
Fairmount	703	37	19	12	42	72	65	30	—	18
Monticello	703	37	19	12	42	72	65	30	—	18
SHELburne BOARDROOM	1,200	45'	27'	18'	—	—	—	20	—	—
VERSAILLES BOARDROOM	703	37'	19'	12'	—	—	—	20	—	—